

4-electrode conductivity sensor cartridge 35660-94

<p>CE Conformable standards This equipment conforms to the following standards: RoHS: EN50581 9. Monitoring and control instruments</p>	<p>Authorised representative in EU</p>
--	---

■ Specification

Cell constant	1.72×0.1 cm ⁻¹ (1.72×10 m ⁻¹)
Measurement range	10 μS/cm to 2000 mS/cm (1 mS/m to 200.0 S/m) *Displayable range depends on the meter.
Sample temperature	0 to 70 °C (Up to 100 °C for the sensor cartridge only)
Storage condition	0 to 40 °C In the dry air
Materials	Body :Epoxy / Glass epoxy Electrode :Carbon
Size	φ16 mm × 110 mm (Immersible area)

■ Caution

- Remove the rubber cap of the plug before use.
- Push the plug into the sensor head keeping connectors dry.
- Avoid using a rusted plug.
- Rinse carefully the sensor cartridge with pure water before use.
- Calibrate with standard solution before use or enter the cell constant of the label attached. Calibrate regularly with a standard solution.
- Avoid sudden temperature change even within the operating temperature range.
- Rinse carefully the residues on the sensor cartridge with pure water before measuring sample with low conductivity.
- If the electrode part becomes dirty, clean it with a soft cloth and rinse with pure water.

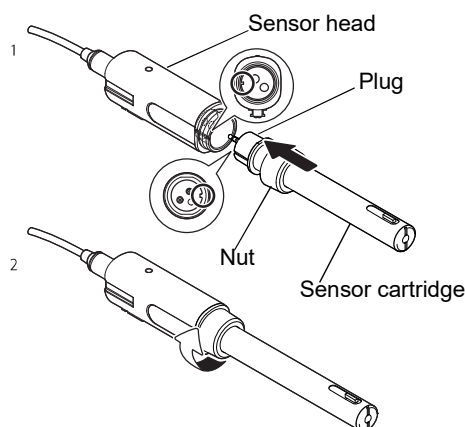

1. Connect the slot of the sensor cartridge with the marker of the sensor head and push into the sensor head.
2. Tighten the nut firmly until the nut is totally tight on the sensor head.

Note

In the absence of O-ring or in the case where the nuts is not tight enough, liquids might flow into the connection space and cause malfunction.