

## SERIES TSS2

## DUAL STAGE TEMPERATURE SWITCH

Two Independent Relay Outputs, Heating or Cooling Control

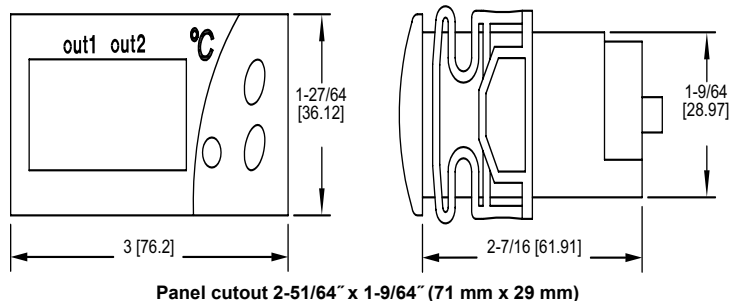

The **Series TSS2 Dual Stage Temperature Switch** features two independent sensor inputs and control outputs in one device.

## BENEFITS/FEATURES

- Simple to use dual temperature control device
- Configuration key

## APPLICATIONS

- Refrigerators
- Chillers
- Food service equipment
- Medical sterilizers or equipment

MODEL CHART		
Model	Supply Power	Unit
TSS2-2100	115 VAC	°F
TSS2-2110	115 VAC	°C
TSS2-2210	230 VAC	°C
TSS2-2300	12 VAC/DC	°F
TSS2-2400	24 VAC/DC	°F

## ACCESSORIES

See page reference ❶ below.

## SPECIFICATIONS

**Probe Range:** PTC: - 58 to 302°F (-50 to 150°C); NTC: -58 to 230°F (-50 to 110°C).  
**Input:** PTC (1000 Ω @ 25°C); NTC (10 kΩ @ 25°C).  
**Outputs:** OUT1=SPDT relay rated 16 A @ 240 VAC resistive; OUT2=SPDT relay rated 8 A @ 240 VAC resistive.  
**Horsepower Rating (HP):** 1 HP (OUT1).  
**Power Requirements:** 115 VAC, 230 VAC, 12 VAC/VDC or 24 VAC/VDC (depending on model).  
**Accuracy:** ±1% FS.  
**Display:** 3-digit and sign, red LED.  
**Resolution:** 0.1° (< 100°); 1° (≥ 100°).  
**Memory Backup:** Nonvolatile memory.  
**Temperature Limit:** Ambient: 32 to 158°F (0 to 70°C).  
**Storage Temperature:** -4 to 176°F (-20 to 80°C).  
**Dimensions:** 3 x 1-27/64 x 2-7/16 in.  
**Weight:** 2.3 oz (65 g).  
**Front Panel Rating:** IP64.  
**Compliance:** CE, cURus.

❶ Digital Temperature Switch Probes and Accessories: See page 129 (Series TS-Probes)