

DREMEL®



Detailer's Grip Attachment Model A577

⚠ WARNING Read and understand the manual for the use of the tool with this accessory.

SAVE THESE INSTRUCTIONS

⚠ WARNING Prevent fingers from making contact with rotating bit.

⚠ CAUTION Do not tighten detailer's grip over shaft lock button.

Attachment for use with Dremel Rotary Tool Models 100, 200, 300, 400, 4000, 800, 275, 285, 395, 398.

The attachment comes with its own nose piece to tighten the handle to the tool.

Detailer's Grip Attachment Installation Instructions

Step 1: Remove the housing cap **A** from the end of the tool and set housing cap aside. The original housing cap must be reinstalled when this attachment is not used (Fig. 1).

Step 2 & 3: Place handle **B** over housing collar **C** with the handle in the desired position and securely tighten the handle **B** with the nose piece **D** that's provided with handle (Fig. 2).

Make sure detailer's grip is fully secured before using tool.

Note: Attachment may not install flush onto tool's housing.

Removing the Detailer's Grip Attachment

Step 1 & 2: Hold the handle **B** firmly and twist the tool until the nose piece **D** is loose. Remove

nose piece **D** and handle **B** from housing collar **C** and reinstall original housing cap **A** (Fig. 2).

Introduction

This attachment is designed to give you the ultimate precision and control when working on your projects. It is designed for you to hold and control the tool like a pencil, between your thumb and forefinger. When held in this position you can hardly feel the weight of the tool. It is meant to be an extension of your hand. To be comfortable with the Detailer's Grip it is important to get the "feel" of it. (See drawings for recommended way to hold)

The Dremel Detailer's Grip is intended to be used on applications such as finishing sanding, engraving, carving, etching, polishing, and cleaning, to name a few.

1. Pencil Grip – For best control of the Detailer's Grip, hold the tool like a pencil between your thumb and forefinger (Fig. 3).
2. Side Grip – Rotate the tool sideways, with the handle pointing out while resting your hand on the table (Fig. 4).
3. Stable Grip – For ultimate stability, rest the handle of the tool on the table to help stabilize and control the accessory (Fig. 5).

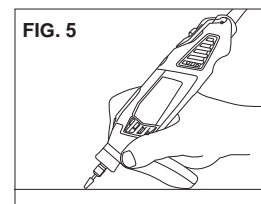
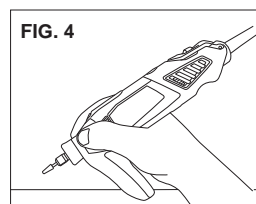
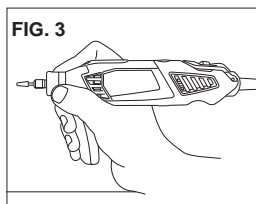
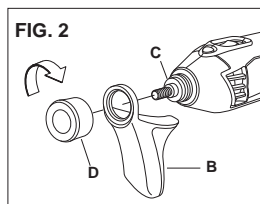
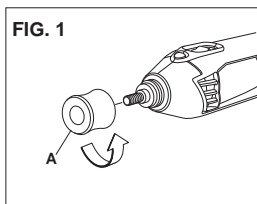

2610958466 03/09

Printed in Mexico