

QTY.	DESCRIPTION	CAT./UPC NO.	KEY
1	Ratcheting 1" Box End Wrench	34941	A
1	3/8" Draw Stud	00042	B
1	3/4" Draw Stud	304AVBB/04042	C
1	1/2" Slug-Buster® Conduit Punch	721-1/2/31756	D
1	1/2" Conduit Die	14722	D
1	3/4" Slug-Buster® Conduit Punch	721-3/4/31757	E
1	3/4" Conduit Die	124AV/06972	E
1	1" Slug-Buster® Conduit Punch	712-1/31758	F
1	1" Conduit Die	126AV/04011	F
1	1-1/4" Slug-Buster® Conduit Punch	721-1-1/4/31759	G
1	1-1/4" Conduit Die	128AV/04013	G
1	1-1/2" Slug-Buster® Conduit Punch	721-1-1/2/31760	H
1	1-1/2" Conduit Die	440AV/04061	H
1	2" Slug-Buster® Conduit Punch	721-2/31761	I
1	2" Conduit Die	442AV/04063	I
1	Plastic Case	34758	

## PARTS LIST

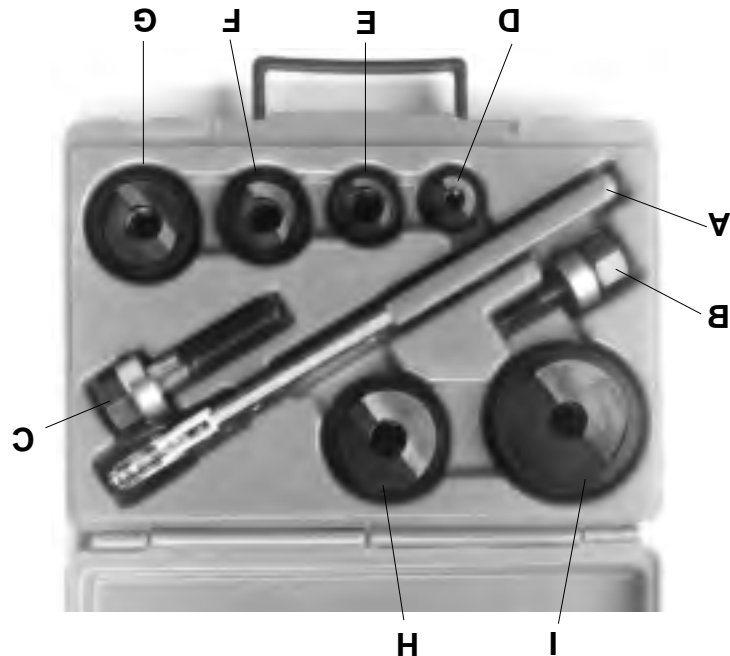

## GREENLEE® 7238SB SLUG-BUSTER® PUNCH SET WITH RATCHETING WRENCH

### INSTRUCTIONS AND PARTS LIST

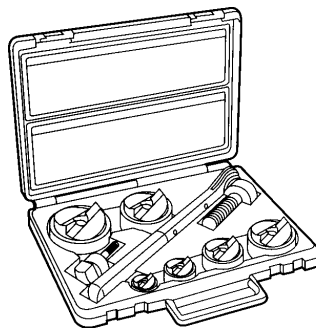

**GREENLEE®**

**7238SB SLUG-BUSTER®**  
1/2" Thru 2" Knockout Punch Set  
with Ratcheting Wrench

**GREENLEE TEXTRON**



Read and understand this material before operating. Failure to understand how to safely operate the Slug Buster® set could result in an accident causing serious injury or death. This tool should only be operated by qualified personnel.

Printed in U.S.A.

999 9611.1

© 1996 Greenlee Textron

IM-1067 Rev 4 9/96

1.888.610.7664



[www.calcert.com](http://www.calcert.com)

[sales@calcert.com](mailto:sales@calcert.com)

## **GREENLEE® 7238SB SLUG-BUSTER® PUNCH SET WITH RATCHETING WRENCH**

### **WARNING**

Do not punch enclosures containing or close to live circuits. Electrical shock could result causing severe injury or death.

**Lubricate threads and cutting edges before use.**

**CAPACITY: 10 ga. mild steel**

### **CAUTION**

- When hole is completed the punch unit (punch, die and draw stud) can fall free toward the die side.
- Make sure you have firm footing and balance when operating. Position yourself to avoid injuries in case of slippage, breakage or any other loss of control while punching.

## **OPERATING INSTRUCTIONS — SAVE THESE INSTRUCTIONS!**



**1** The 1/2" conduit size punch requires 3/8" or larger pilot hole. Use Greenlee Kwik Stepper pilot step drills.

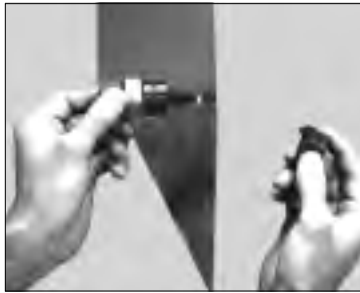

**2** Place 1/2" conduit die on 3/8" draw stud. Insert draw stud through pilot hole.

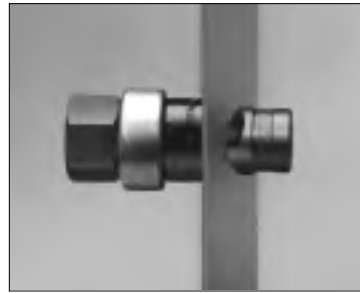

**3** Thread punch on draw stud with cutting edge toward material being punched.



**4** Turn draw stud clockwise with the 34941 wrench until material is punched.

**CAUTION:** punch will become free of hole and could fall.



**5** Disassemble punch by turning draw stud counterclockwise while holding punch. Tip die and drop out split slugs.



**6** For 3/4" through 2" conduit sized holes use 304AVBB 3/4" draw stud. Place selected size die on draw stud. Insert draw stud in 3/4" or larger pilot hole.\* Thread same size punch on the draw stud with the cutting edge toward the material being punched.



**7** Turn draw stud clockwise with 34941 wrench until material is punched.

**CAUTION:** punch will become free of hole and could fall.



**8** Disassemble punch by turning draw stud counter-clockwise while holding punch. Tip die and drop out split slugs.

**\* Time Saver:** Use 1/2" conduit punch to make 7/8" pilot hole for 3/4"-2" conduit punches.