

# I N S T R U C T I O N S

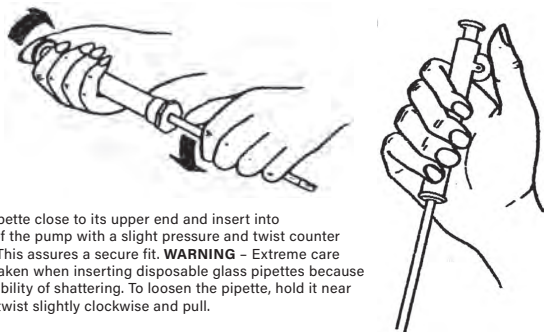

## The Pipette Pump™

Catalog No. 37896-0000, 37897-0000, 37898-0000, 37899-0000



### 1. Assembly

Hold the pipette close to its upper end and insert into the chuck of the pump with a slight pressure and twist counter clockwise. This assures a secure fit. **WARNING** – Extreme care should be taken when inserting disposable glass pipettes because of the possibility of shattering. To loosen the pipette, hold it near the chuck, twist slightly clockwise and pull.

### 2. Operation

The length and diameter of THE PIPETTE PUMP™ fit the hand comfortably, providing in ease and accuracy of operation. Constructed with acid-resistant and practically unbreakable plastic. Submerge the end of the pipette into the solution and turn the operating wheel with the thumb. Fluid will be drawn into the pipette. To expel fluid, turn the wheel in the opposite direction. For fast emptying, press down on the plunger top.

### 3. Spare Parts for the Pipette Pump™

Model	Pipette Chuck	Silicone Washers (set)
F37896-0000	H93789-0060	H93789-0061
F37897-0000	H93789-0070	H93789-0071
F37898-0000	H93789-0080	H93789-0081
F37899-0000	H93789-0090	H93789-0091



999320617 – 08/18

Pipette Pump™ is a trademark of Bel-Art – SP Scienceware.  
Bel-Art – SP Scienceware assumes no obligation or liability for any advice furnished by it, or for results obtained with respect to these products.  
All such advice is given and accepted at the buyer's risk.  
© 2018. All Rights Reserved.  
Bel-Art® – SP Scienceware® is a division of SP Industries, Inc.



# I N S T R U C T I O N S



## The Pipette Pump™

Catalog No. 37896-0000, 37897-0000, 37898-0000, 37899-0000

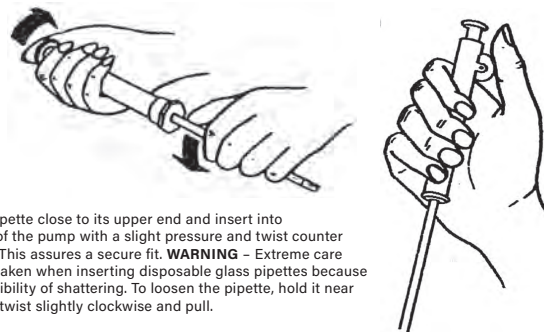

### 1. Assembly

Hold the pipette close to its upper end and insert into the chuck of the pump with a slight pressure and twist counter clockwise. This assures a secure fit. **WARNING** – Extreme care should be taken when inserting disposable glass pipettes because of the possibility of shattering. To loosen the pipette, hold it near the chuck, twist slightly clockwise and pull.

### 2. Operation

The length and diameter of THE PIPETTE PUMP™ fit the hand comfortably, providing in ease and accuracy of operation. Constructed with acid-resistant and practically unbreakable plastic. Submerge the end of the pipette into the solution and turn the operating wheel with the thumb. Fluid will be drawn into the pipette. To expel fluid, turn the wheel in the opposite direction. For fast emptying, press down on the plunger top.

### 3. Spare Parts for the Pipette Pump™

Model	Pipette Chuck	Silicone Washers (set)
F37896-0000	H93789-0060	H93789-0061
F37897-0000	H93789-0070	H93789-0071
F37898-0000	H93789-0080	H93789-0081
F37899-0000	H93789-0090	H93789-0091



999320617 – 08/18

Pipette Pump™ is a trademark of Bel-Art – SP Scienceware.  
Bel-Art – SP Scienceware assumes no obligation or liability for any advice furnished by it, or for results obtained with respect to these products.  
All such advice is given and accepted at the buyer's risk.  
© 2018. All Rights Reserved.  
Bel-Art® – SP Scienceware® is a division of SP Industries, Inc.

