

**BLANK (CALIBRATION)**
**HIGH RANGE TOTAL CHLORINE**

ColorQ 2x Range

0-999 ppm

# 1 Blank

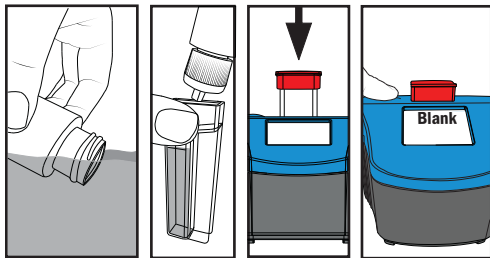

1. Fill sample bottle (0689) with water sample. Replace cap.
2. Fill clean tube (0206) to the line with water sample. Cap tube with red cap.
3. Insert tube into the ColorQ 2x.
4. Press button to turn meter on. When "Blank" appears press button to "Blank" the meter and go to "HR TCL" High Range Total Chlorine. Remove tube.

# 2 HR TCL

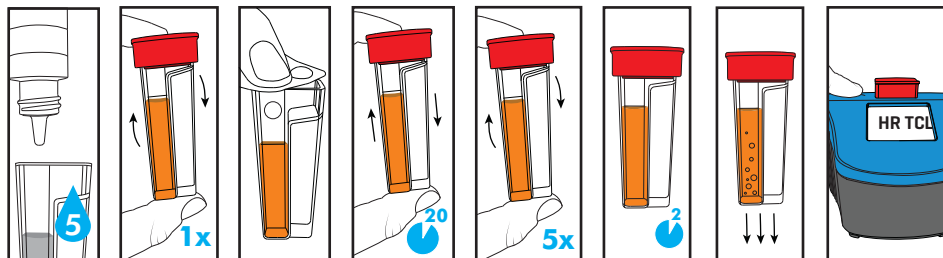
 \*Chlorine Reagent #2  
 4499WT-H/4499WT-CN-H  
 DPD 3 IG 6197A-J/6197A-CN-J

1. Add 5 drops **Chlorine Reagent #2** to same tube. Cap tube with red cap.
2. Invert tube 1 time to mix.
3. Add 1 **DPD 3 IG** tablet. Cap tube with red cap. Shake for TWENTY seconds. Invert slowly 5 times.
4. Allow tube to sit for TWO minutes. Tap tube on surface 3 times to remove air bubbles.
5. Insert tube into the ColorQ 2x. Press button to read "HR TCL" High Range Total Chlorine.
6. Press button to return to blank meter or hold button until 0 is displayed. Remove tube.

**NOTE:** Wash and rinse tubes and caps immediately after use. Tubes used for the high range chlorine test may become stained. Stain will not wash out. Stain may fade if stained tubes and caps are placed in direct natural light or sunlight. Replace heavily stained tubes.

**INTERFERENCES:** bromine, chlorine dioxide, iodine, oxidized manganese and chromium, and ozone.

**WARNING!** This set contains chemicals that may be harmful if misused. Read cautions on individual containers carefully. Not to be used by children except under adult supervision.



\*Reagent is a potential health hazard.  
**READ SDS:** lamotte.com **Emergency information:**  
 Chem-Tel USA 1-800-255-3924 Int'l, call collect, 813-248-0585



\*El reactivo es un potencial de salud peligro.  
**LEER SDS:** lamotte.com **Información de emergencia:**  
 Chem-Tel EE. UU. 1-800-255-3924 Internacional, llamada por cobrar, 813-248-0585



\*Le réactif est un potentiel de santé risquer.  
**LIRE SDS:** lamotte.com **Information d'urgence:**  
 Chem-Tel États-Unis 1-800-255-3924 International, à frais virés, 813-248-0585



- Read the instructions before testing.
- Press button to turn meter ON and OFF.
- Quickly press button twice to skip a test.
- Cap the tubes securely to prevent leaks.
- Do not interchange color-coded caps.
- Dry the tubes before placing them in the chamber.
- Rinse tablet crusher after each use. Brush and rinse tubes, caps and tablet crusher after testing.
- Allow the tubes to dry before returning them to the case.
- The tube specified in the test procedure must be used.
- Use only LaMotte reagents. Cap securely.
- If unit should auto-off during testing, rinse and fill a tube. Repeat Blank and return to testing.

