

# 7 COMBUSTION ANALYSIS & SAVING

**WARNING!** - Before proceeding with the combustion analysis remember to set the proper fuel.

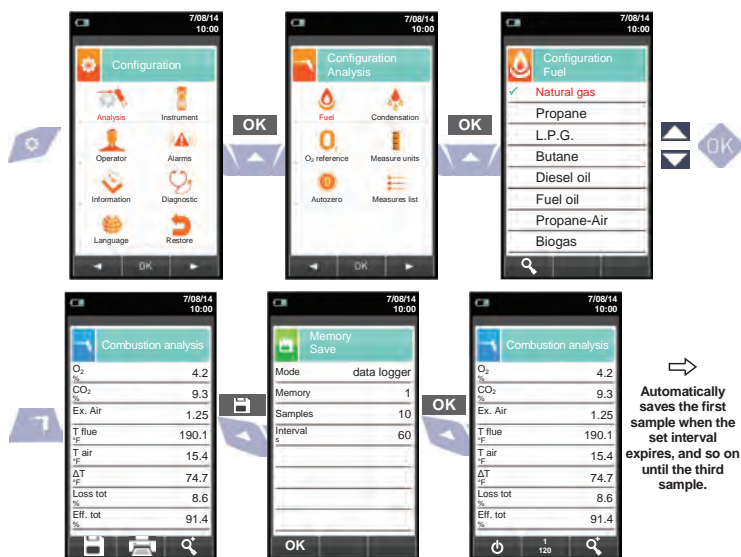

In case the automatic print mode is set then the average analysis printing start automatically. Conversely, after the sampling of the third analysis, the average analysis is shown, so that it can be sent to the printer as explained in the following.

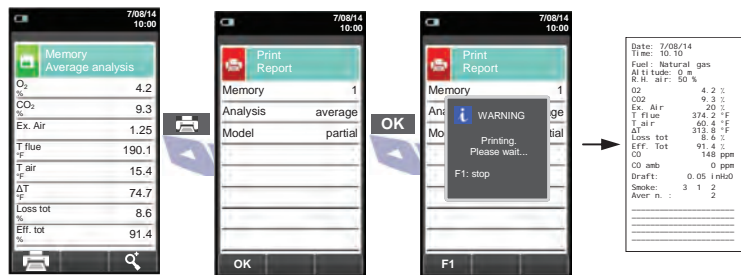

• To view different test measurements, use 'Find' key to scroll through the various test measurement screens.  
**Xair** = Excess Air  
**Tg** = Flue Gas Stack Temperature    **Ta** = Ambient or Incoming Air Temperature  
**ΔT** = Differential Temperature (NET Temperature)    **Eff. tot** = Total Combustion Efficiency    **Loss tot** = Stack Losses

# 1500 QUICK GUIDE



Compliant with: EN 50379-1, EN 50379-2

COMPLETE MANUAL ON USB FLASH DRIVE

## Features

- Combustion, Flue gas & Emissions analysis
- Calculating of stack heat loss and efficiency
- CO environment measurement
- Measuring differential pressure
- Draft measurement
- Pressure measurement in the gas supply pipe
- Store Smoke values, calculating mean value



The magnets in the back of the instrument can damage credit cards, hard drives, mechanical watches, pacemakers, defibrillators and other devices proven sensitive to magnetic fields. It is recommended to keep the instrument at a distance of at least 10" away from any of these devices.

## KEYBOARD FUNCTIONS

KEYS	FUNCTION
[Up]	Activate the context keys shown on the display
[Save]	Enters the Memory menu
[Print]	Enters the Print menu
[Config]	Enters the Configuration menu
[Back]	Previes the combustion analysis
[Measure]	Enters the measurements menu
[Power]	Turns the instrument on/off
[Esc]	Quits the current screen
[Cursor]	Selects and/or modifies
[OK]	Confirms data

## CONTEXT KEYS

CONTEXT KEY	FUNCTION
[Zero]	ZERO the pressure sensor
[Refresh]	Updates the measure
[Save]	Saves the current measurement or analysis in the memory location selected from the 'Select Memory' menu
[Print]	Starts the report ticket
[Print]	Enters the Print menu
[Power]	Stops the flue gas analysis
[Modify]	Enters the modify mode for the selected parameter
[OK]	Confirms the settings
[Esc]	Cancels the change/operation and returns to the previous screen
[Find]	Zooms the screen
[Find]	Shows the details for the selected parameter
[Find]	'Find' function; starts a quick search for the analysis to recall



E Instruments respects the nature and the environment, therefore provides this quick user guide to avoid any unwanted waste of paper. However the complete manual for use and maintenance of the instrument is already available in the USB stick (included).  
 Respect your environment: think before printing the full manual on paper.

K000000000EJ 027995 010217



# 1 USING THE FLUE GAS ANALYSER

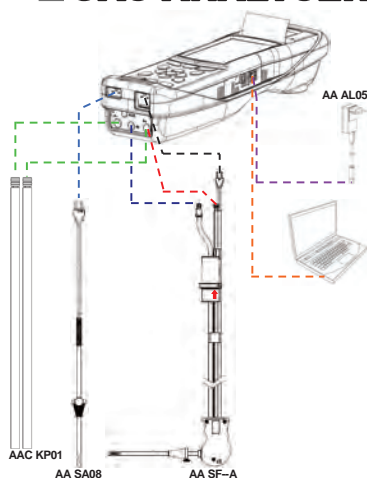

**WARNING!**

- Be sure all connections are tight to assure accurate sampling.
- It is important that water trap & filter be installed vertically to prevent damage from moisture & particles to sensors.
- When conducting measurements, the water trap/filter assembly **MUST** be in a VERTICAL position.
- When testing is completed, always drain the water trap with any condensation (after EVERY test!).

# 2 ON / OFF

**WARNING!**  
During autozero **DO NOT** insert the gas probe in the chimney.



KEEP  
PRESSED  
FOR 2  
SECONDS  
UNTIL IT  
BEEPS

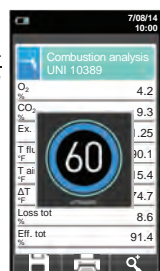

# 3 PRIMARY OUTDOOR TEMP. INPUT



It saves the value, acquired or entered in the parameter 'Air T'.

Acquires the temperature value detected from the sampling probe. That value is reported in the parameter 'Air T'.

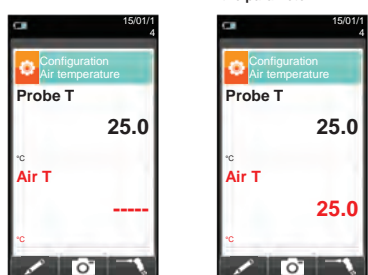

# 4 HOW TO STOP / RESTART PUMP

While in manual analysis, holding pressed both keys **ESC** and **ENTER** makes the instrument switch off the suction fumes pump and blocks the refresh of any current measure.

To switch on the suction fumes pump again and reactivate the refresh of the current measure, press again the keys **ESC** and **ENTER**.

# 5 MEASURE OF THE DRAFT

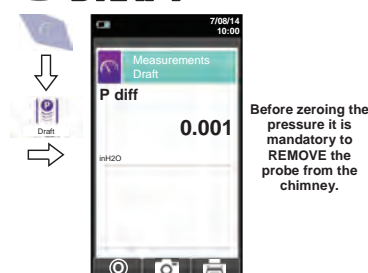

Before zeroing the pressure it is mandatory to **REMOVE** the probe from the chimney.

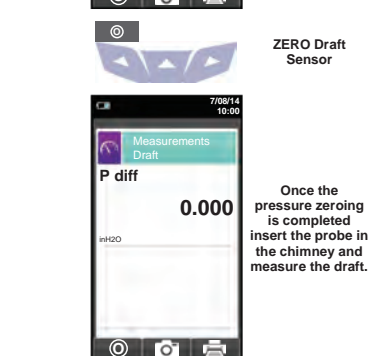

ZERO Draft Sensor

Once the pressure zeroing is completed insert the probe in the chimney and measure the draft.

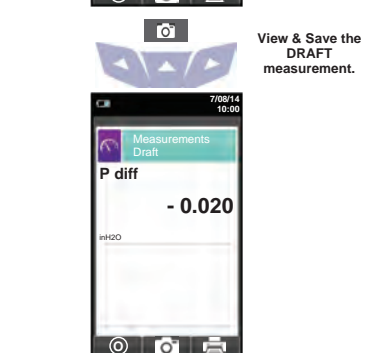

View & Save the DRAFT measurement.

# 6 MEASURE AMBIENT CO



It is mandatory to perform the instrument autozero in fresh, clean outdoor air.

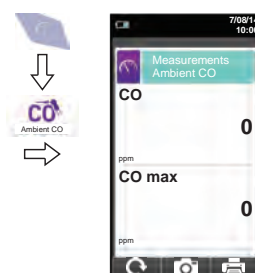

Connect the gas probe to the instrument and perform the measurement. Wait 5 minutes.



Save the measurement

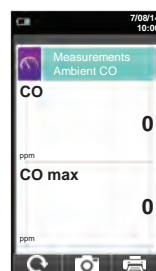

K000000000EJ 027995 010217